

K-ReeL

2012 COLLECTION



◀ KLARCO®



Experience, technology and an advanced business culture: the groundworks for the reliability leading to leadership.

KLARCO designs and manufactures heavy-duty faucets, pre-rinse units and retractable hose reel spray units.

Throughout its history, dating back to 1985, KLARCO has always skilfully combined research aimed at qualitative excellence with a continuous expansion of its product range, in response to the evolution of the areas in which its products are used and the specific characteristics required.

KLARCO has achieved the position of market leader through cutting edge design and production technologies, along with experience, professionally trained personnel and proprietary business insight.

An additional competitive advantage is the company's location near the North-Eastern Italian city of Pordenone, at the heart of an active industrial region driving the Italian economy. This strategic location favours relations with most European countries, where KLARCO products enjoy a solid reputation.





Reliability and efficiency in a wide and diverse range of products

One of KLARCO's strengths is fulfilling the promise inherent in its mission, hence providing top-performing solutions: hygiene, durability, ergonomics and design through the use of carefully selected materials, such as stainless steel and rubber suitable for food contact.

The product range is divided into several collections, spanning over different quality and price levels.

Designing and creating KLARCO products, we always keep in mind their intended use, i.e. professional kitchen and food processing environment, workplaces where the use of high quality machinery enhances the efficiency and safety, improving the working conditions and ensuring the highest level of hygiene.





MAXIReeL M20 M15 M10

TECHNICAL DATA

Conceived for the rinsing of ample surfaces and built with materials suitable for professional kitchens and other food-processing and food-service environments.



MAXIReeL M20 Hose length: 20 m

Without spray gun (G 1/2 male thread)

Art. 5R.M20.G12

With NiTo-II Combi spray gun

Art. 5R.M20.449

With NiTo-II spray gun + extension

Art. 5R.M20.480

With NiTo-I Combi spray gun

Art. 5R.M20.448

With NiTo-I spray gun + extensi

Art. 5R.M20.450

With NEW spray gun

Art. 5R.M20.045

MAXIReeL M15 Hose length: 15 m

Without spray gun (G 1/2 male thread)

Art. 5R.M15.G12

With NiTo-II Combi spray gun

Art. 5R.M15.449

With NiTo-II spray gun + extension

Art. 5R.M15.480

With NiTo-I Combi spray gun

Art. 5R.M15.448

With NiTo-I spray gun + extensi

Art. 5R.M15.450

With NEW spray gun

Art. 5R.M15.045

MAXIReeL M10 Hose length: 10 m

Without spray gun (G 1/2 male thread)

Art. 5R.M10.G12

With NiTo-II Combi spray gun

Art. 5R.M10.449

With NiTo-II spray gun + extension

Art. 5R.M10.480

With NiTo-I Combi spray gun

Art. 5R.M10.448

With NiTo-I spray gun + extensi

Art. 5R.M10.450

With NEW spray gun

Art. 5R.M10.045

WEIGHT

MAXIReeL M20 24 kg (53 lb) appx.

MAXIReeL M15 23 kg (51 lb) appx.

MAXIReeL M10 16 kg (36 lb) appx.

Operating Conditions

Intended to operate with water only, not mixed with other substances such as detergents.

Water temperature and pressure

Operating conditions vary with each spray gun (cf page 13).

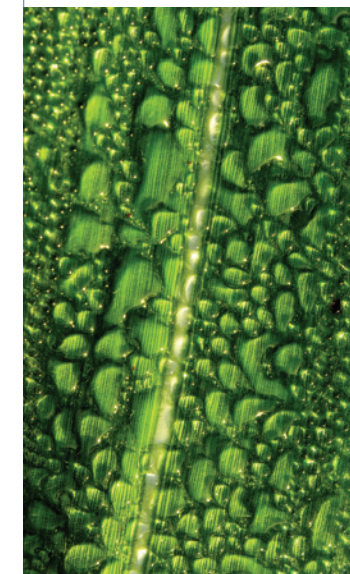

K-ReeL

2012 COLLECTION

CARE FOR EVERY DETAIL

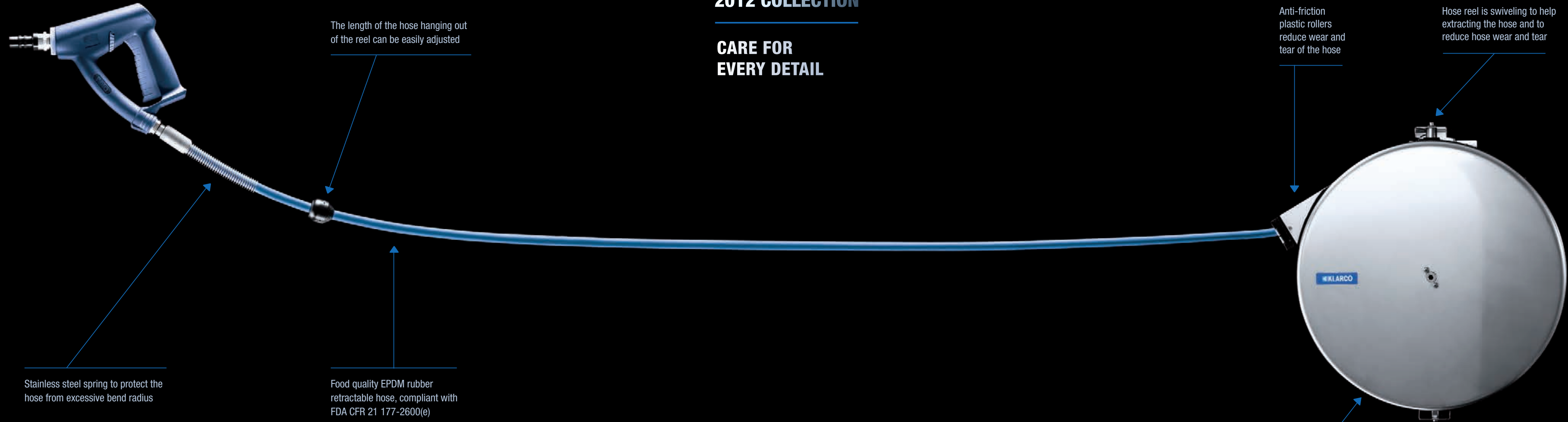

The length of the hose hanging out of the reel can be easily adjusted

Anti-friction plastic rollers reduce wear and tear of the hose

Hose reel is swiveling to help extracting the hose and to reduce hose wear and tear

Stainless steel spring to protect the hose from excessive bend radius

Food quality EPDM rubber retractable hose, compliant with FDA CFR 21 177-2600(e)

BSP G 1/2 male-threaded inlet with embedded backflow preventer

The strength of the retraction spring can be adjusted at will

Wall bracket and casing in polished AISI 304 stainless steel





ENVIRONMENTAL TECHNOLOGY

K-Reel are designed and developed in accordance with HACCP guidelines, built with eco-friendly materials and in compliance with FDA and RoHS specifications.

MIDIReel M6 TECHNICAL DATA

- MIDIReel M6T**
 Without spray gun (G 1/2 male thread)
 Art. 5R.M6T.G12
- With NiTo-I Combi spray gun
 Art. 5R.M6T.448
- With NiTo-I spray gun + extension
 Art. 5R.M6T.450
- With NEW spray gun
 Art. 5R.M6T.045
- With NEW/F spray gun
 Art. 5R.M6T.041



WEIGHT
MIDIReel M6T 11 kg (24 lb) appx.

Operating Conditions
Intended to operate with water only, not mixed with other substances such as detergents.

Water temperature and pressure
Operating conditions vary with each spray gun (cf page 13).



Conceived for cleaning and rinsing medium-sized surfaces or small and clustered working areas. Thanks to their compact form factor, MIDIReel can be positioned where it would be impossible to install other rinsing devices. Perfect for under-sink or table-side installation.

- MIDIReel M6Q**
 Without spray gun (G 1/2 male thread)
 Art. 5R.M6Q.G12
- With NiTo-I Combi spray gun
 Art. 5R.M6Q.448
- With NiTo-I spray gun + extension
 Art. 5R.M6Q.450
- With NEW spray gun
 Art. 5R.M6Q.045
- With NEW/F spray gun
 Art. 5R.M6Q.041



WEIGHT
MIDIReel M6Q 11 kg (24 lb) appx

Operating Conditions
Intended to operate with water only, not mixed with other substances such as detergents.

Water temperature and pressure
Operating conditions vary with each spray gun (cf page 13).



MIDIReel M4

TECHNICAL DATA



Conceived for cleaning and rinsing medium-sized surfaces or small and clustered working areas. Thanks to their compact form factor, MIDIReel can be positioned where it would be impossible to install other rinsing devices. Perfect for under-sink or table-side installation.



MIDIReel M4Q

With KLARCO "ECO/R" spray gun

Art. 5R.M4Q.043

MIDIReel M4T

With KLARCO "ECO/R" spray gun

Art. 5R.M4T.043

WEIGHT

MIDIReel M4T 8 kg (18 lb) appx

Operating Conditions

Intended to operate with water only, not mixed with other substances such as detergents.

Water temperature and pressure Max. 65°C (149°F) and 0.65 MPa (94 psi)

WEIGHT

MIDIReel M4Q 8 kg (18 lb) appx.

Operating Conditions

Intended to operate with water only, not mixed with other substances such as detergents.

Water temperature and pressure Max. 65°C (149°F) and 0.65 MPa (94 psi)

MINIReeL



It was 1994 when KLARCO invented MINIReeL™, a compact automatic retractable hose reel spray unit, initially intended for integration in professional combi ovens. Since then, KLARCO has become the world leader in the design and production of these small hose reels, whose performances and form factor can be easily customized to meet customers' needs. MINIReeL can be installed inside an appliance or under a table or sink.

MINIReeL

MINIReeL basic model

Art. 4R.MINI.KI

Photo above: the first model of MINIReeL, made by KLARCO since 1994.



NiTo-II COMBI SPRAY GUN

► M20-M15-M10-M6T-M6Q

Heavy-duty spray gun for industrial cleaning

- Adjustable spray: for a narrow jet up to 60° wide.
- High efficiency: great rinsing power while saving water.
- Trigger with safety lock to prevent accidental spraying.
- Ergonomic design and heat-insulated handle.
- Adjustable spray nozzle is interchangeable with extension.
- G 1/2 female threaded inlet.

Operating Conditions

Water temperature: max. 90°C (194°F)
Pressure max. 1 MPa (145 psi)

Art. P449



NiTo-I COMBI SPRAY GUN

► M20-M15-M10-M6T-M6Q

Light spray gun for industrial cleaning

- Adjustable spray.
- Ergonomic design.
- Adjustable spray nozzle is interchangeable with extension.
- G 1/2 female threaded inlet.

Operating Conditions

Water temperature: max. 40°C (104°F)
Pressure max. 0.6 MPa (87 psi)

Art. P448

ACCESSORIES



45 CM NOZZLE EXTENSION FOR NiTo SPRAY GUNS

► Spray-gun NiTo- II and spray-gun NiTo- I

- 45 cm (18 in) nozzle extension.
- Interchangeable with NiTo-I and NiTo-II spray nozzles.
- Adjustable spray.

Art. P148



ECO/R HANDSHOWER

► M4T-M4Q-MINIReeL

- Made entirely with materials suitable for drinking water contact.
- Ergonomic design, progressive water flow.
- Water hammer-proof valve.
- Also available with push-button control.
- G 3/8 female threaded inlet.

Operating Conditions

Water temperature: max. 65°C (149°F)
Pressure max. 0.65 MPa (94 psi)

Art. P043



SPRAY GUN "NEW"

► M20-M15-M10-M6T-M6Q

Since 1995, workers in professional and institutional kitchens in over 40 countries have been using the "NEW" Spray Gun, designed and manufactured by KLARCO, along with its "NEW/F" variant. The subject of countless inferior imitations, the "NEW" and "NEW/F" spray guns have been constantly developed and improved over 15 years. Commonly used on pre-rinse units in professional kitchens, these spray guns are also compatible with K-ReeL hose reels wherever an efficient device is needed to rinse objects at close distance.

- Materials suitable with drinking water and food contact.
- Progressive water flow (the more the lever is squeezed, the higher the water flow).
- High efficiency: great rinsing power while saving water.
- Ergonomic design and heat-insulated handle.
- G 1/2 female threaded inlet.



SPRAY GUN "NEW/F"

► M20-M15-M10-M6T-M6Q

Operating Conditions
Water temperature: max. 90°C (194°F)
Pressure max. 0.75 MPa (109 psi)

New

Art. P045/N

New/F

Art. P041

MAXIReel



M20- M15

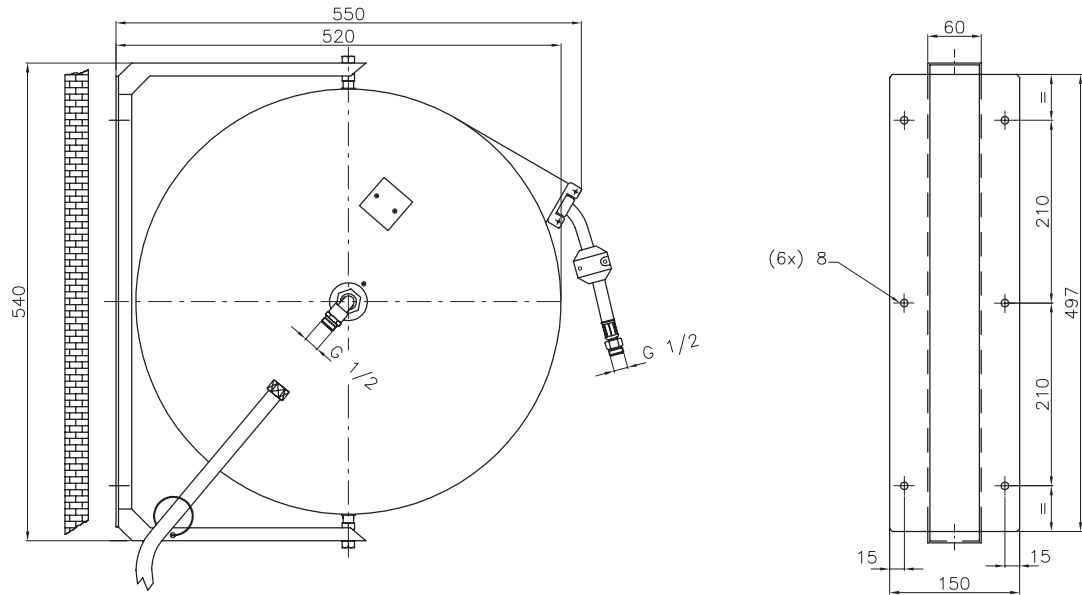

MIDIReel



M6T

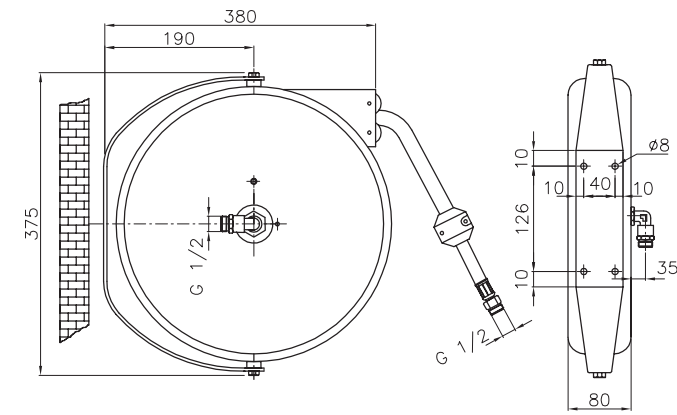

M6Q

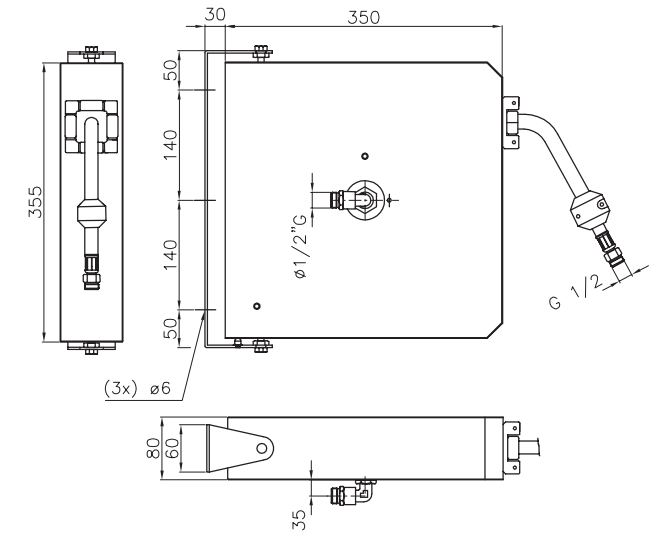

M10

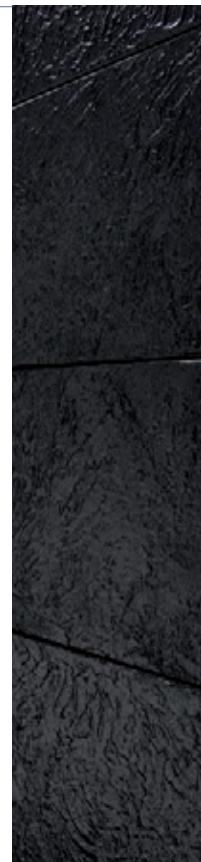
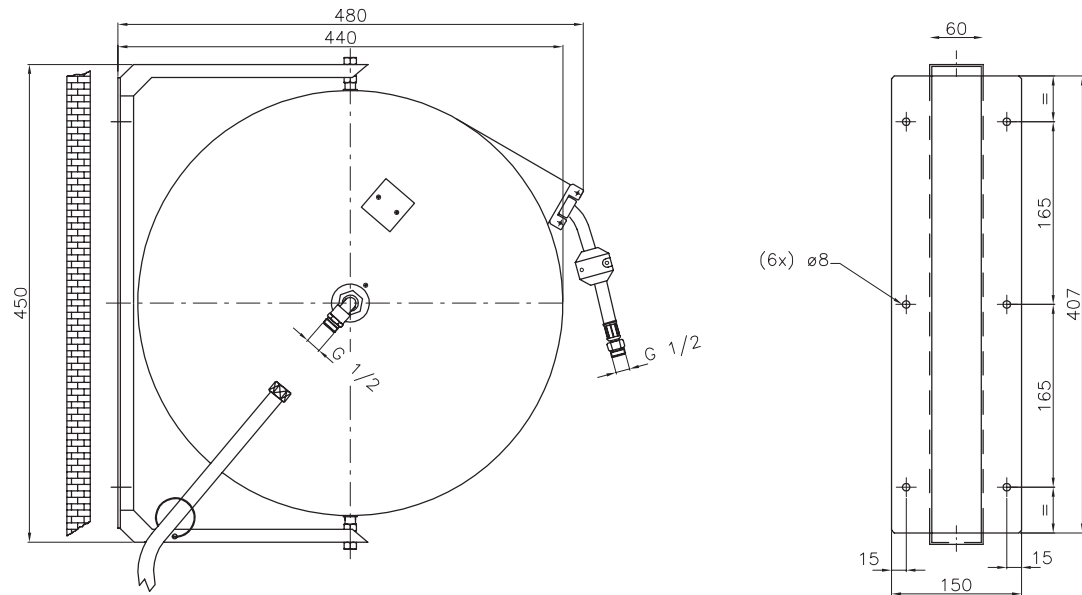

M4T

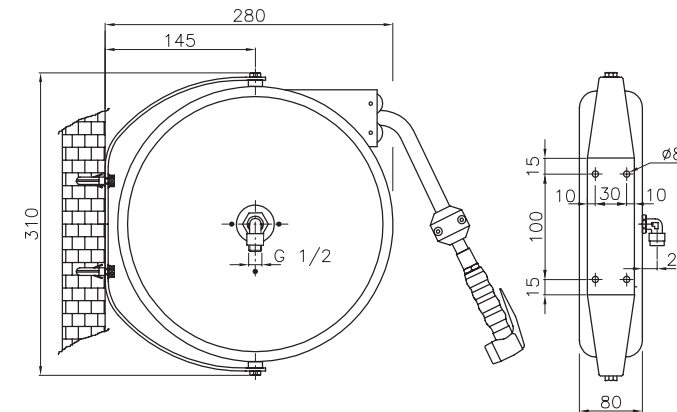

M4Q

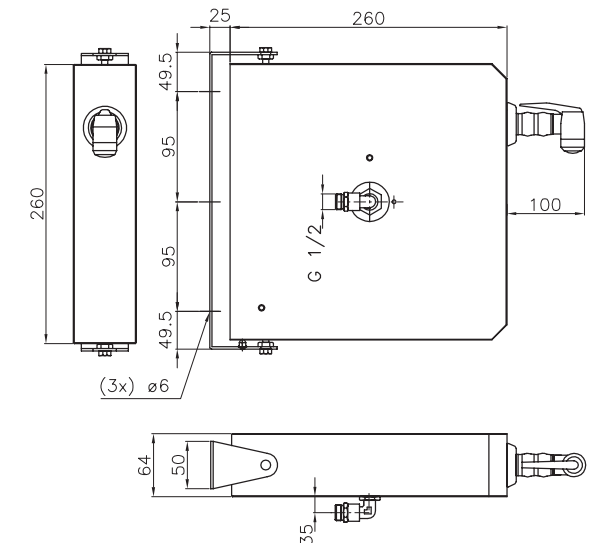



 KLARCO®

All information contained in this catalogue is purely indicative and should not be considered legally binding in any way. KLARCO s.r.l. retains the right to modify without prior notice any information, technical and/or commercial, including article numbers, drawings, pictures, and other technical data contained in this catalogue. KLARCO retains the right to improve and/or modify product dimensions and technical features without prior notice. Product pictures may differ from the actual product. All photographs, drawings, information herein contained are the exclusive property of KLARCO s.r.l. Reproduction and/or distribution, in whole or in part, without the express written consent of KLARCO s.r.l. are strictly prohibited.

Graphics: representa.it
Photography: Franco Zanussi
Printed in October 2013
Document ID: KReel2012en

All contents (except decorative pictures) Copyright © 2012 KLARCO s.r.l. - All rights reserved.



 KLARCO®



KLARCO s.r.l.

via Masieres, 7 z.i.

33080 San Quirino PN - Italy

tel. +39 0434 919422

fax + 39 0434 919494

sales@klarco.com

www.k-reel.com