

Hot Dog Module - Curved Glass

The Look

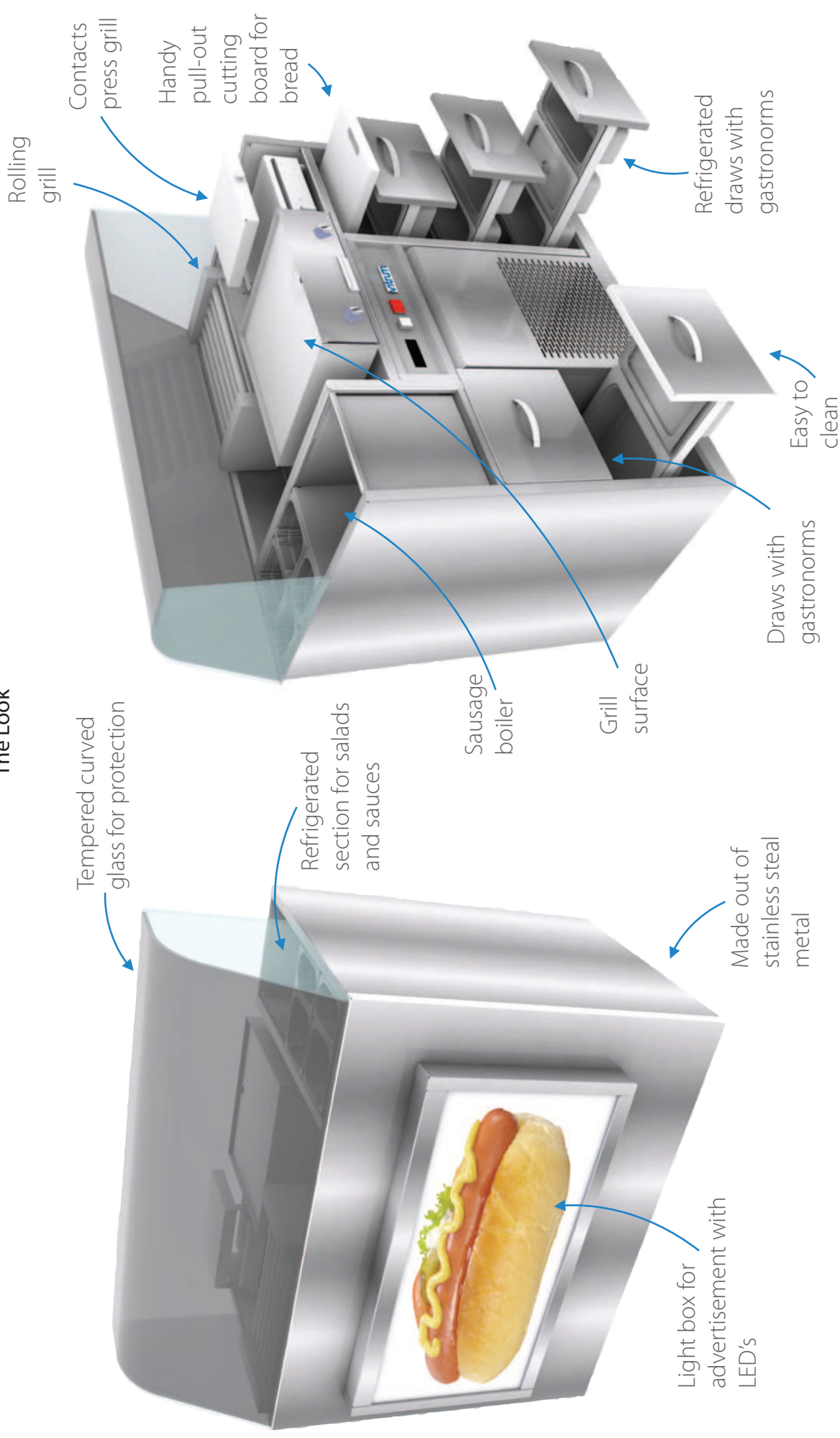

Hot Dog Module - Curved Glass

The Look (Without Sausage Boiler)

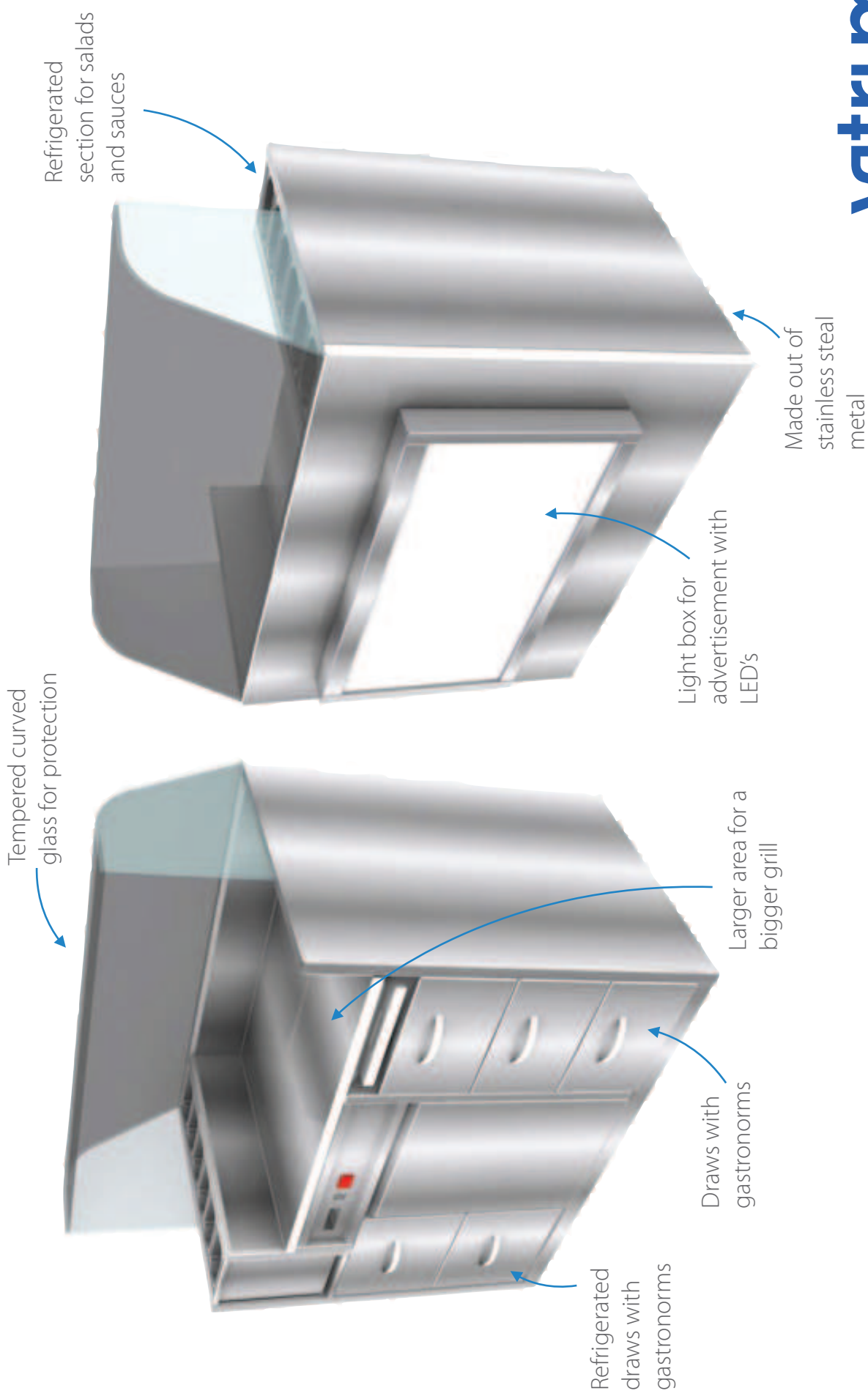

Hot Dog Module HD 900 CG

HD 900 CG (glued curved glass)

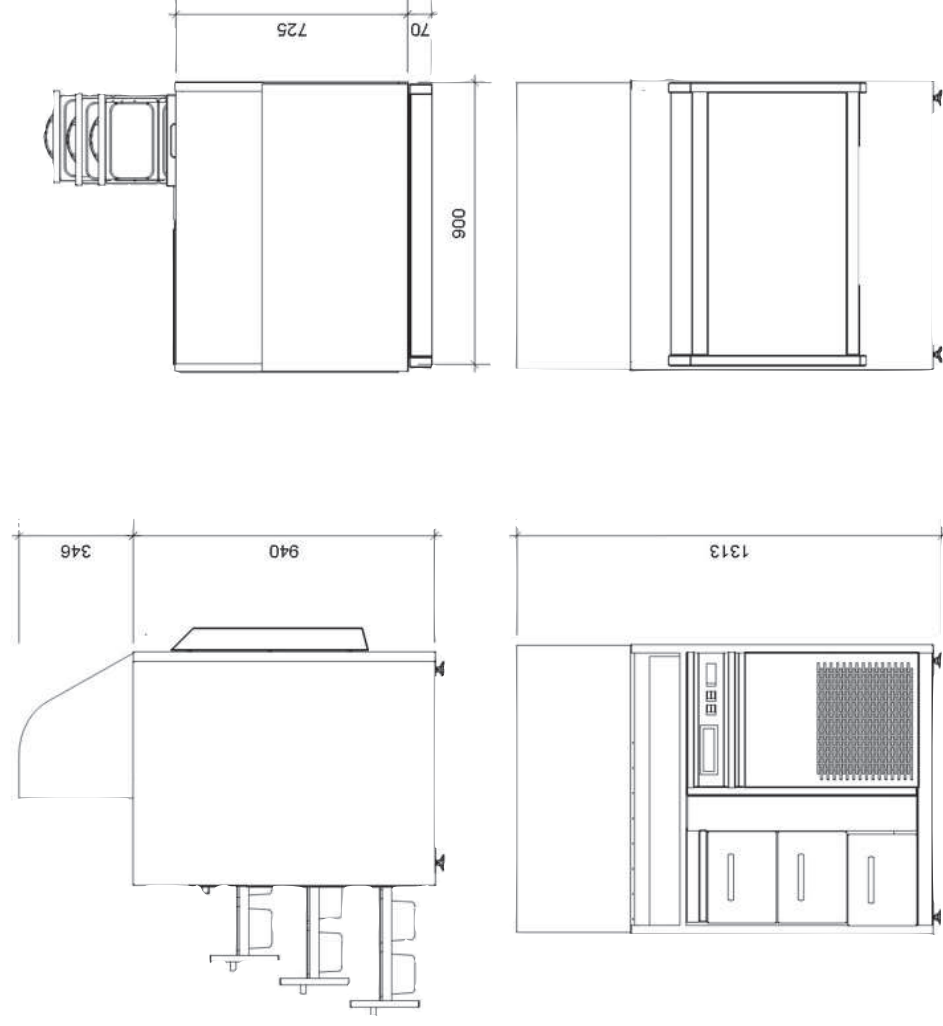

Climate class facilities in accordance with EN441	-3; +25°C RH = 60%
Temperature class of the product	M2; -1...+7°C
Rated Voltage	3~380V, 50Hz
Degree of protection of electrical equipment from electric shock (IEC 61140)	I
Power consumption, kW (total)	4,85kW
Among them:	
Refrigeration unit	0,38kW (6A)
Frontal lighting	0,02kW (6A)
Contact Grill TL5270 *	1,60kW (10A)
Roller Grill GL6R65T *	0,950kW (10A)
Sausage boiler CL-A1D *	n/a
Grill surface GL9520 *	2,0kW (16A)
Type of refrigerant	R134 ^a
The mass of refrigerant for the embedded unit	0,25kg
Net capacity load: litres	
For the refrigerated unit	146
Non refrigerated	0

Possible specifications:

1. Rolling grill with Teflon surface GL6R65T 1100 x 256 x170
2. Contact press grill TL5270 280 x375 x 170
3. Grill surface GL9520 460 x 375 x120
4. Gastro accessories

Hot Dog Module HD 1150 CG

HD 1150 CG (glued curved glass)

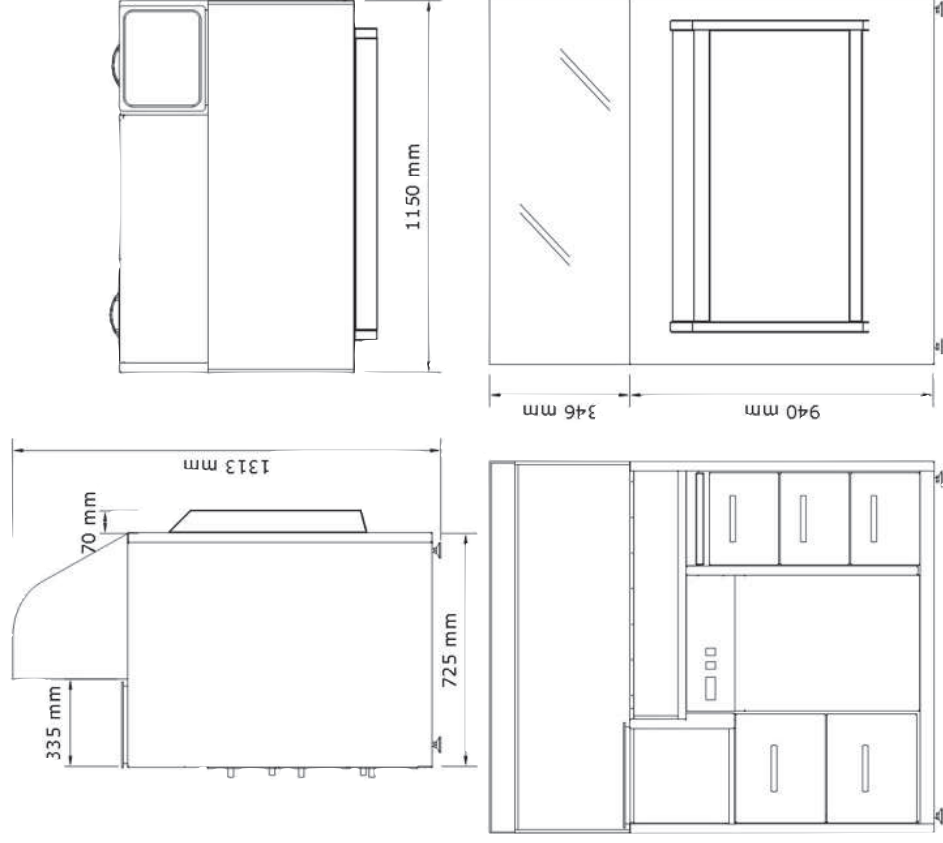

Possible specifications:

1. Rolling grill with Teflon surface GL6R65T 1100 x 256 x 170
2. Contact press grill TL5270 280 x 335 x 170
3. Sausage boiler. CL-A1D 320 x 335 x 300
4. Grill surface GL9520 460 x 375 x 120
5. Gastro accessories

Climate class facilities in accordance with EN441	-3; +25°C RH = 60%
Temperature class of the product	M2; -1...+7°C
Rated Voltage	3~380V, 50Hz
Degree of protection of electrical equipment from electric shock (IEC 61140)	I
Power consumption, kW (total)	5,95kW
Among them:	
Refrigeration unit	0,38kW (6A)
Frontal lighting	0,02kW (6A)
Contact Grill TL5270 *	1,60kW (10A)
Roller Grill GL6R65T *	0,950kW (10A)
Sausage boiler CL-A1D *	1,0kW (10A)
Grill surface GL9520 *	2,0kW (16A)
Type of refrigerant	R134 ^a
The mass of refrigerant for the embedded unit	0,25kg
Net capacity load: litres	
For the refrigerated unit	162
Non refrigerated	134

Hot Dog Module HD 1200 CG

HD 1200 CG (glued curved glass)

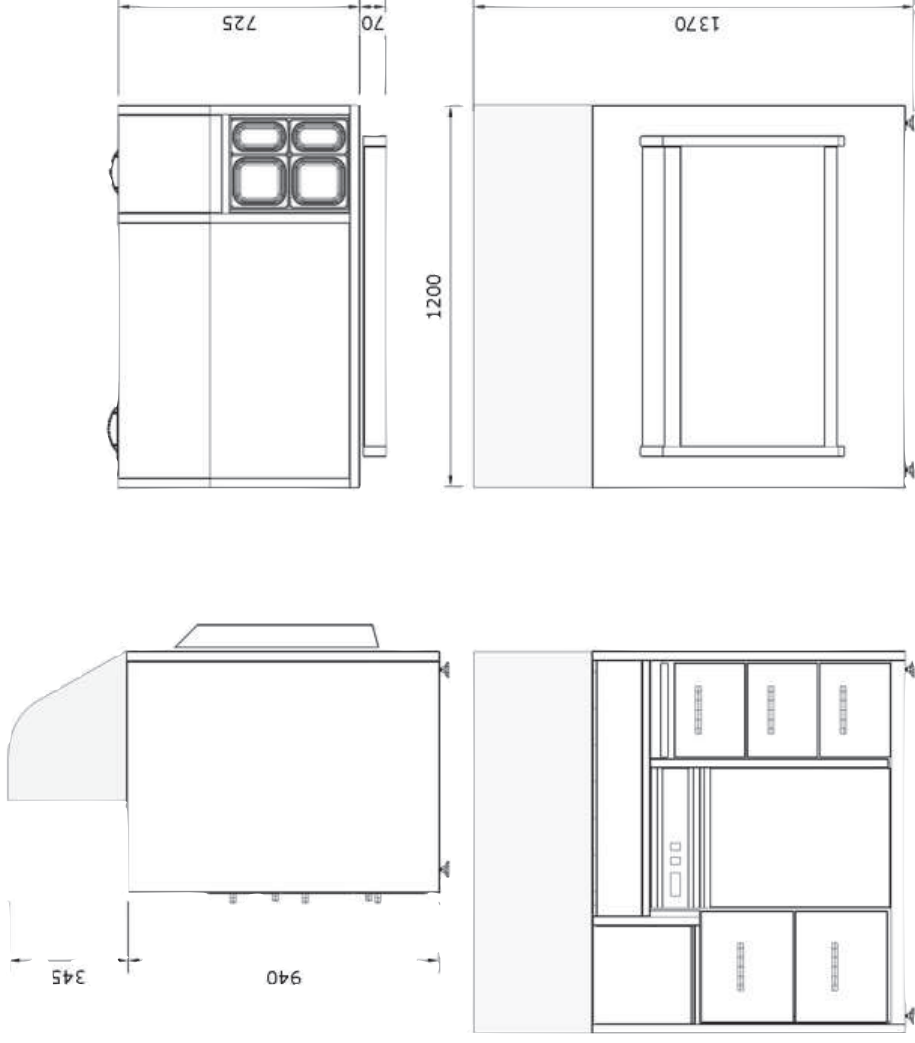

Possible specifications:

1. Rolling grill with Teflon surface GL6R65T 1100 x 256 x 170
2. Contact press grill TL5270 280 x 375 x 170
3. Sausage boiler. CL-A1D 320 x 335 x 300
4. Grill surface GL9520 460 x 375 x 120
5. Gastro accessories

Climate class facilities in accordance with EN441	-3; +25°C RH = 60%
Temperature class of the product	M2; -1...+7°C
Rated Voltage	3~380V, 50Hz
Degree of protection of electrical equipment from electric shock (IEC 61140)	I
Power consumption, kW (total)	5,95kW
Among them:	
Refrigeration unit	0,38kW (6A)
Frontal lighting	0,02kW (6A)
Contact Grill TL5270 *	1,60kW (10A)
Roller Grill GL6R65T *	0,950kW (10A)
Sausage boiler CL-A1D *	1,0kW (10A)
Grill surface GL9520 *	2,0kW (16A)
Type of refrigerant	R134 ^a
The mass of refrigerant for the embedded unit	0,25kg
Net capacity load: litres	
For the refrigerated unit	160
Non refrigerated	134

Hot Dog Module HD 1200 CG - 2

HD 1200 CG - 2 (glued curved glass, no sausage boiler)

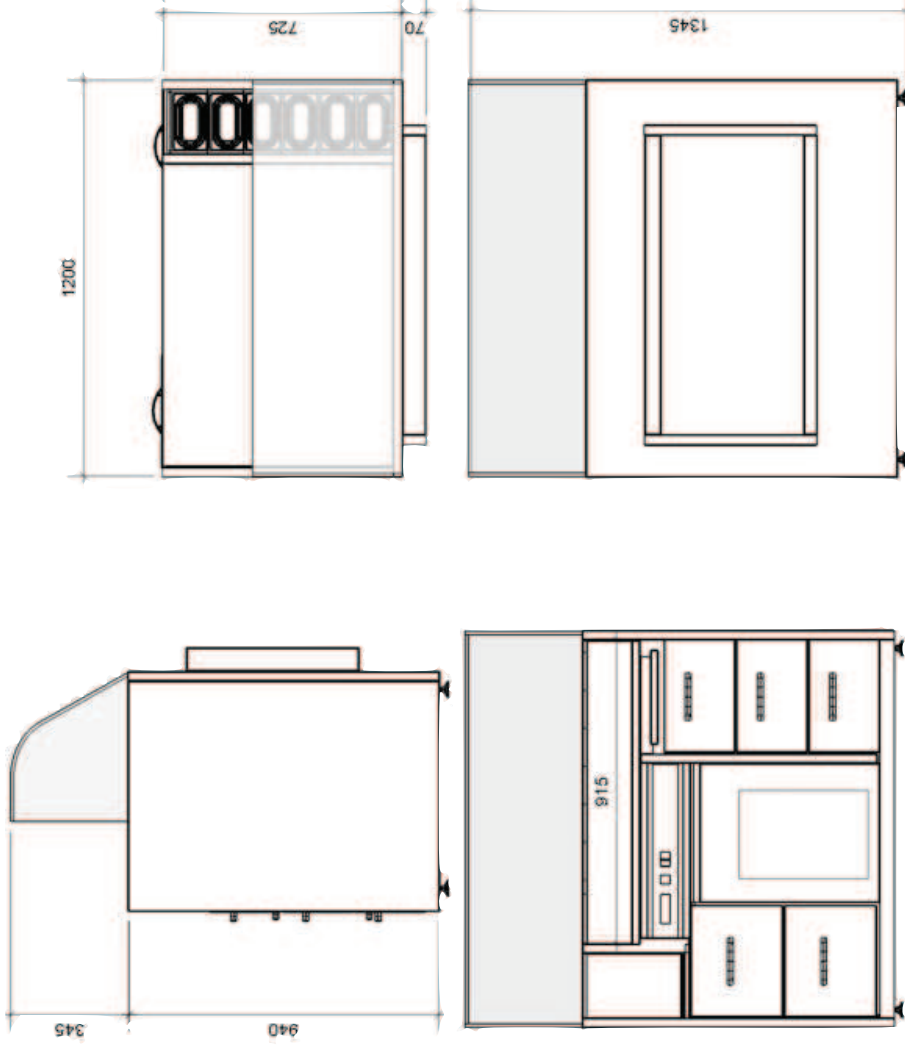

Climate class facilities in accordance with EN441	-3; +25°C RH = 60%
Temperature class of the product	M2; -1...+7°C
Rated Voltage	3~380V, 50Hz
Degree of protection of electrical equipment from electric shock (IEC 61140)	I
Power consumption, kW (total)	4,85kW
Among them:	
Refrigeration unit	0,38kW (6A)
Frontal lighting	0,02kW (6A)
Contact Grill TL5270 *	1,60kW (10A)
Roller Grill GL6R65T *	0,950kW (10A)
Sausage boiler CL-A1D *	n/a
Grill surface GL9520 *	2,0kW (16A)
Type of refrigerant	R134 ^a
The mass of refrigerant for the embedded unit	0,25kg
Net capacity load: litres	
For the refrigerated unit	160
Non refrigerated	134

Possible specifications:

1. Rolling grill with Teflon surface GL6R65T 1100 x 256 x170
2. Contact press grill TL5270 280 x375 x 170
3. Grill surface GL9520 460 x 375 x120
4. Gastro accessories

Hot Dog Module HD 1550 CG

HD 1550 CG (glued curved glass)

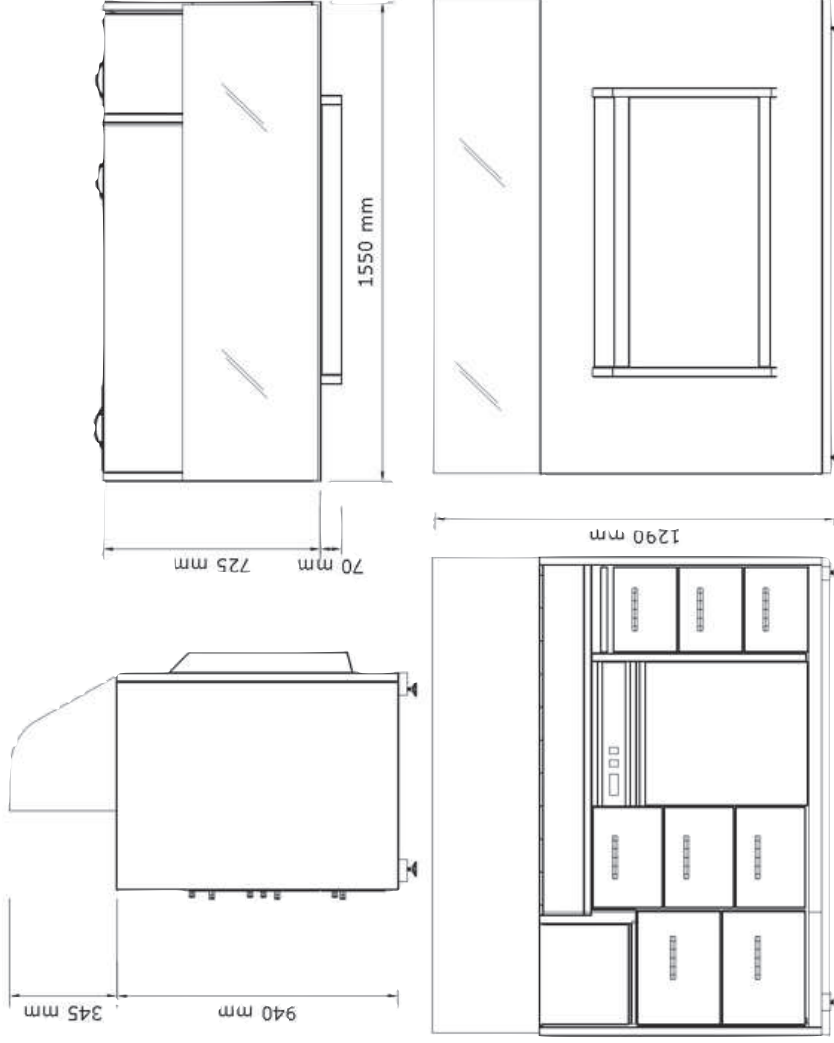

Climate class facilities in accordance with EN441	-3; +25°C RH = 60%
Temperature class of the product	M2; -1...+7°C
Rated Voltage	3~380V, 50Hz
Degree of protection of electrical equipment from electric shock (IEC 61140)	I
Power consumption, kW (total)	5,95kW
Among them:	
Refrigeration unit	0,38kW (6A)
Frontal lighting	0,02kW (6A)
Contact Grill TL5270 *	1,60kW (10A)
Roller Grill GL6R65T *	0,950kW (10A)
Sausage boiler CL-A1D *	1,0kW (10A)
Grill surface GL9520 *	2,0kW (16A)
Type of refrigerant	R134 ^a
The mass of refrigerant for the embedded unit	0,25kg
Net capacity load: litres	
For the refrigerated unit	254
Non refrigerated	134

Possible specifications:

1. Rolling grill with Teflon surface GL6R65T 1100 x 256 x170
2. Contact press grill TL5270 280 x375 x 170
3. Sausage boiler. CL-A1D 320 x 335 x 300
4. Grill surface GL9520 460 x 375 x120
5. Gastro accessories

Hot Dog Module HD 1600 CG

HD 1600 CG (glued curved glass)

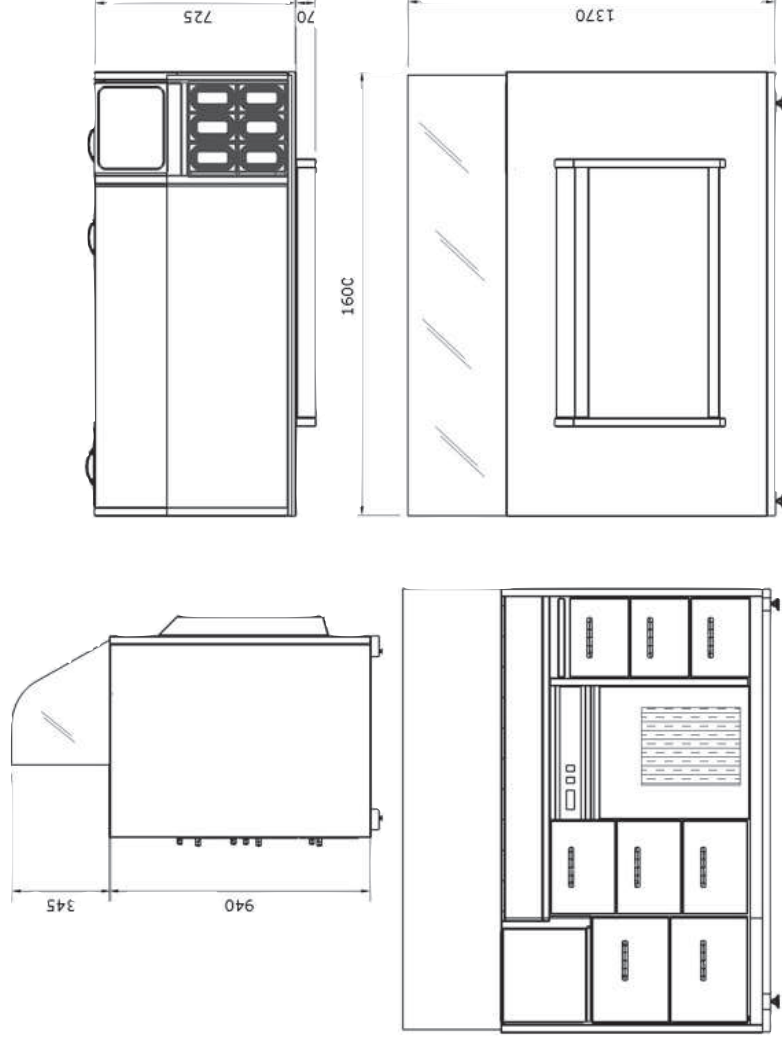

Climate class facilities in accordance with EN441	-3; +25°C RH = 60%
Temperature class of the product	M2; -1...+7°C
Rated Voltage	3~380V, 50Hz
Degree of protection of electrical equipment from electric shock (IEC 61140)	I
Power consumption, kW (total)	5,95kW
Among them:	
Refrigeration unit	0,38kW (6A)
Frontal lighting	0,02kW (6A)
Contact Grill TL5270 *	1,60kW (10A)
Roller Grill GL6R65T *	0,950kW (10A)
Sausage boiler CL-A1D *	1,0kW (10A)
Grill surface GL9520 *	2,0kW (16A)
Type of refrigerant	R134 ^a
The mass of refrigerant for the embedded unit	0,25kg
Net capacity load: litres	
For the refrigerated unit	340
Non refrigerated	134

Possible specifications:

1. Rolling grill with Teflon surface GL6R65T 1100 x 256 x 170
2. Contact press grill TL5270 280 x 375 x 170
3. Sausage boiler. CL-A1D 320 x 335 x 300
4. Grill surface GL9520 460 x 375 x 120
5. Gastro accessories

Hot Dog Module HD 1600 CG - 2

HD 1600 CG - 2 (glued curved glass, no sausage boiler)

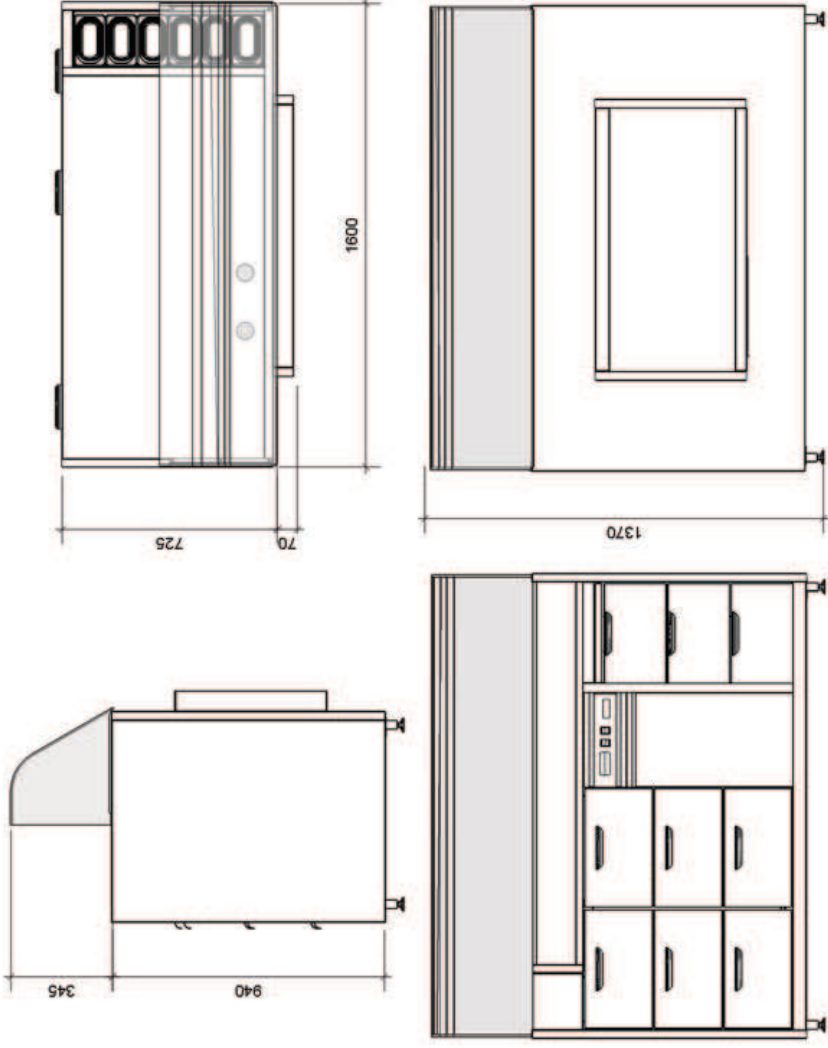

Climate class facilities in accordance with EN441	-3; +25°C RH = 60%
Temperature class of the product	M2; -1...+7°C
Rated Voltage	3~380V, 50Hz
Degree of protection of electrical equipment from electric shock (IEC 61140)	I
Power consumption, kW (total)	4,85kW
Among them:	
Refrigeration unit	0,38kW (6A)
Frontal lighting	0,02kW (6A)
Contact Grill TL5270 *	1,60kW (10A)
Roller Grill GL6R65T *	0,950kW (10A)
Sausage boiler CL-A1D *	n/a
Grill surface GL9520 *	2,0kW (16A)
Type of refrigerant	R134 ^a
The mass of refrigerant for the embedded unit	0,25kg
Net capacity load: litres	
For the refrigerated unit	340
Non refrigerated	134

Possible specifications:

1. Rolling grill with Teflon surface GL6R65T 1100 x 256 x170
2. Contact press grill TL5270 280 x375 x 170
3. Grill surface GL9520 460 x 375 x120
4. Gastro accessories

Hot Dog Module Straight Glass

The Look

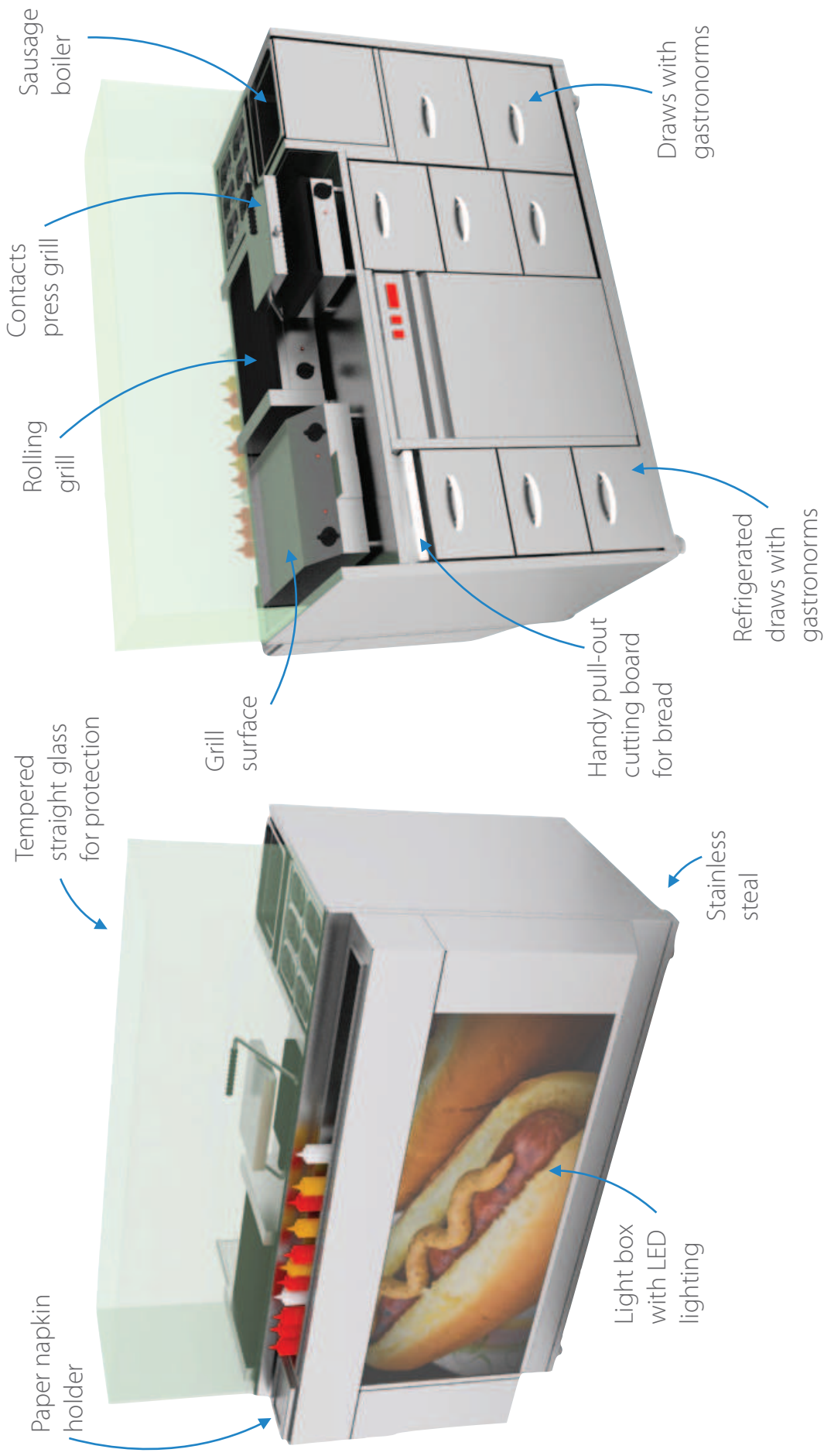

Hot Dog Module HD 1200 SG

2 variations: HD 1200 SG (glued straight glass) - HD 1200 ASG (assembled straight glass)



Climate class facilities in accordance with EN441	-3; +25°C RH = 60%
Temperature class of the product	M2; -1...+7°C
Rated Voltage	3~380V, 50Hz
Degree of protection of electrical equipment from electric shock (IEC 61140)	I
Power consumption, kW (total)	5,95kW
Among them:	
Refrigeration unit	0,38kW (6A)
Frontal lighting	0,02kW (6A)
Contact Grill TL5270 *	1,60kW (10A)
Roller Grill GL6R65T *	0,950kW (10A)
Sausage boiler CL-A1D *	1,0kW (10A)
Grill surface GL9520 *	2,0kW (16A)
Type of refrigerant	R134 ^a
The mass of refrigerant for the embedded unit	0,25kg
Net capacity load: litres	
For the refrigerated unit	160
Non refrigerated	134

Possible specifications:

1. Rolling grill with Teflon surface GL6R65T 1100 x 256 x 170
2. Contact press grill TL5270 280 x 375 x 170
3. Sausage boiler. CL-A1D 320 x 335 x 300
4. Grill surface GL9520 460 x 375 x 120
5. Gastro accessories

Hot Dog Module HD 1600 SG

2 variations: HD 1600 SG (glued straight glass) - HD 1600 ASG (assembled straight glass)

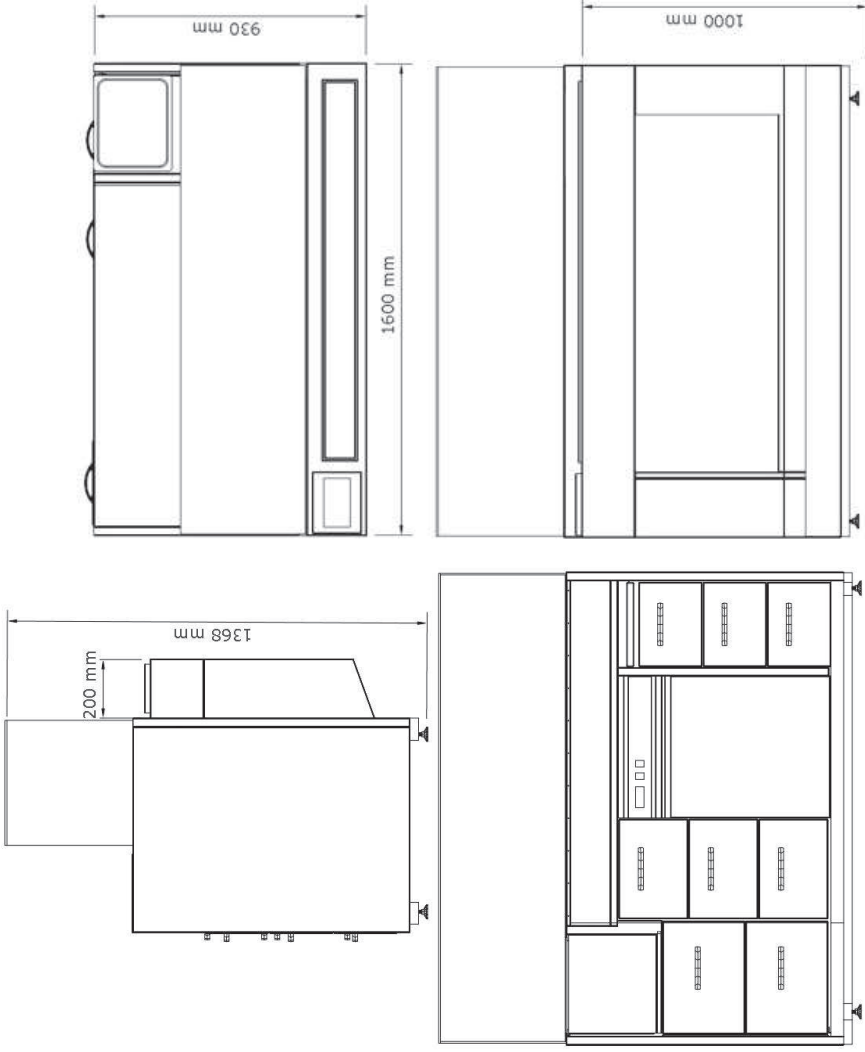

Climate class facilities in accordance with EN441	-3; +25°C RH = 60%
Temperature class of the product	M2; -1...+7°C
Rated Voltage	3~380V, 50Hz
Degree of protection of electrical equipment from electric shock (IEC 61140)	I
Power consumption, kW (total)	5,95kW
Among them:	
Refrigeration unit	0,38kW (6A)
Frontal lighting	0,02kW (6A)
Contact Grill TL5270 *	1,60kW (10A)
Roller Grill GL6R65T *	0,950kW (10A)
Sausage boiler CL-A1D *	1,0kW (10A)
Grill surface GL9520 *	2,0kW (16A)
Type of refrigerant	R134 ^a
The mass of refrigerant for the embedded unit	0,25kg
Net capacity load: litres	
For the refrigerated unit	310
Non refrigerated	134

Possible specifications:

1. Rolling grill with Teflon surface GL6R65T 1100 x 256 x170
2. Contact press grill TL5270 280 x375 x 170
3. Sausage boiler. CL-A1D 320 x 335 x 300
4. Grill surface GL9520 460 x 375 x120
5. Gastro accessories